

International House Guide

(国際交流会館ガイド)

International House

- ・国際交流会館は、教員棟と学生棟で構成されている宿舎です。

The International House consists of student wing and Faculty wing.

- ・学生棟には留学生とResident Assistant (RA; 成蹊大学の学生)が入居し、普段から国際交流ができます。

International students and Resident Assistants (RA; Seikei Students) reside in the student building, and international exchange takes place regularly.

Location

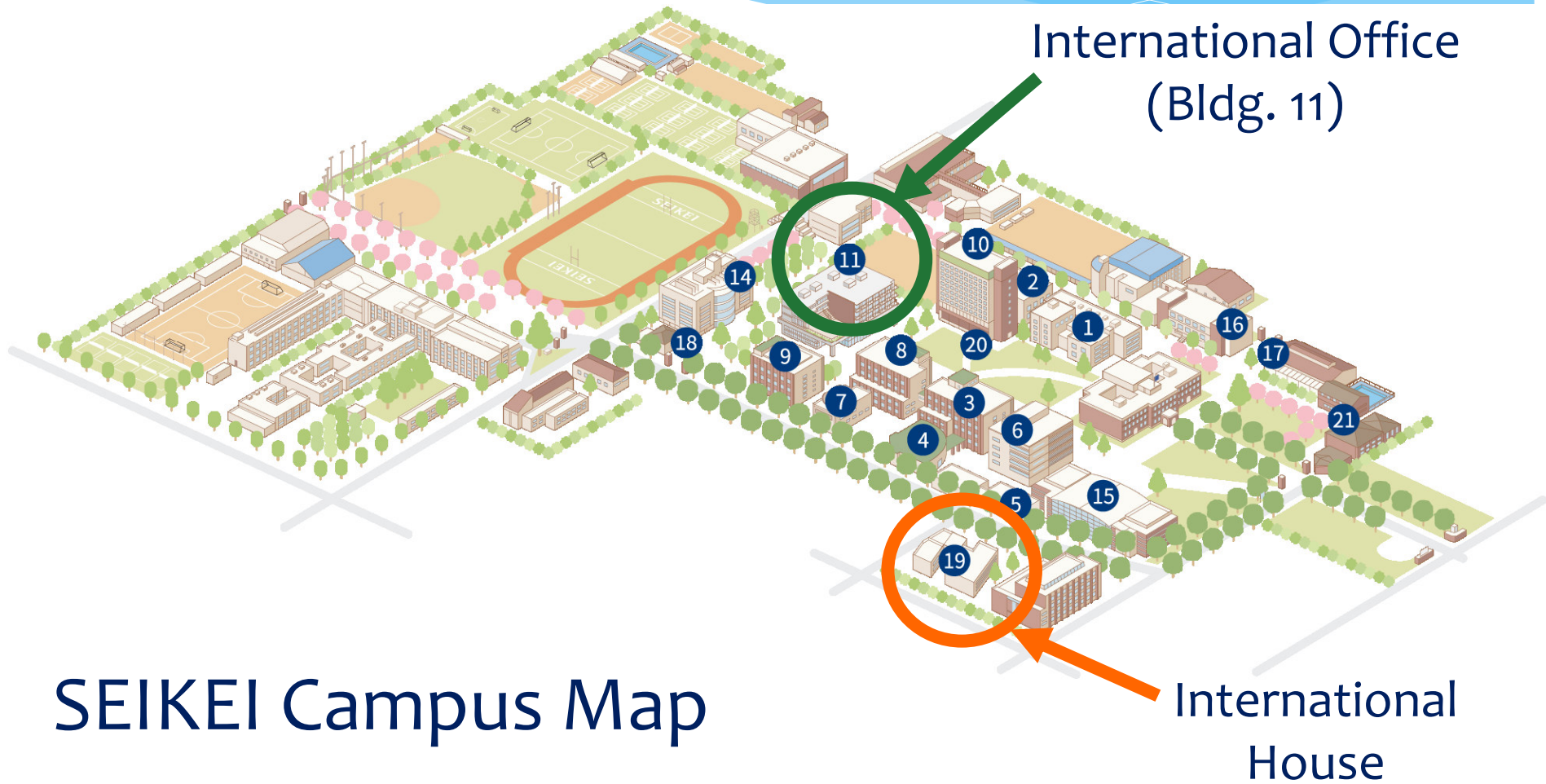

Interior/exterior



Exterior



Main Entrance



Dormitory Office



Shared student entrance



Common Room for Student

Private room (20m²)

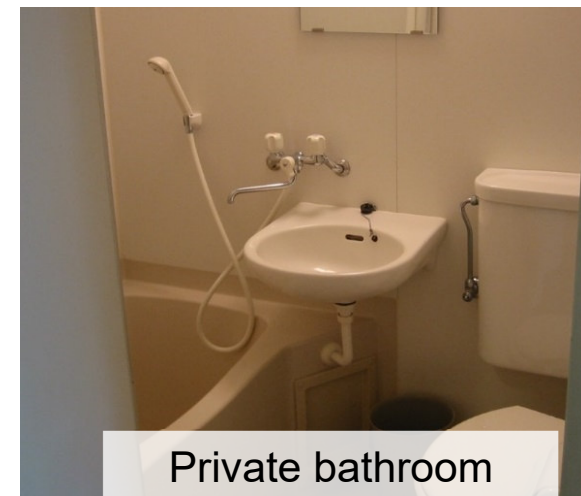
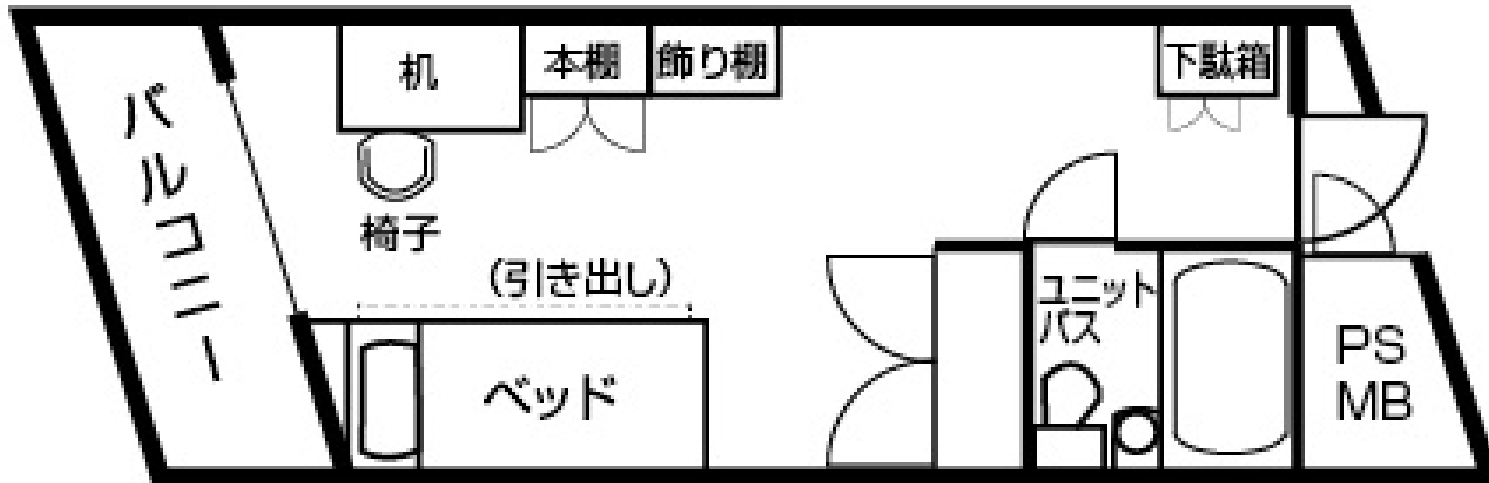

Private room (20m²)

Available

Unit-bathroom,
Single bed,
Desk & chair,
Bookshelf,
Wardrobe,
Trash can,
Shoe rack,
Air conditioner,
Interphone,
Wi-Fi

Option Required

Bedding & linen lease

Common Room for Student

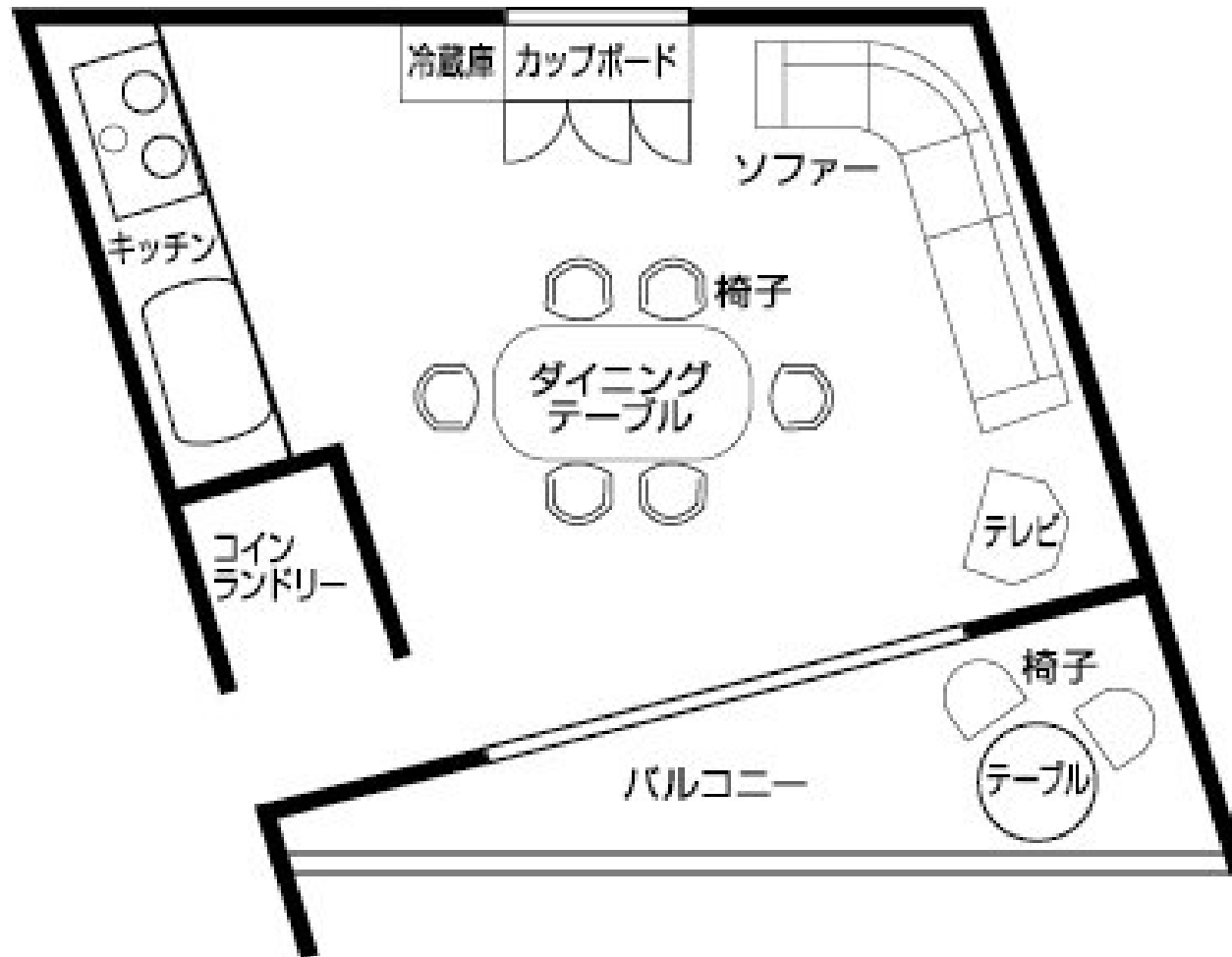

*Five private rooms share one common room.



Kitchen in student
common room



Laundromat



terrace

Common Room for Student

Available

Kitchen,
Microwave,
Toaster,
Refrigerator,
Cupboard,
Dining table/ chair,
TV,
Air conditioner,
Vacuum cleaner,
Coin Laundries

Prepare by yourself

Cookware,
Tableware

“The international house, Kokusaikouryu-kaikan” (国際交流会館)

< Address >

3-6-35 Kichijoji-Kitamachi, Musashino-shi Tokyo, 180-0001 Japan

<Access>

20-minute walk from Kichijoji station / 1-minute walk from Seikei University

<Descriptions>

- All single rooms (20.00m², Furnished)
- No meals, Kitchen available, Common Room for Student
- Resident manager on site
(except Sundays, national holidays, and year-end and New Year holidays)
- Curfew : 00:00 – 06:30AM